

GEF...ES (d 12~150)

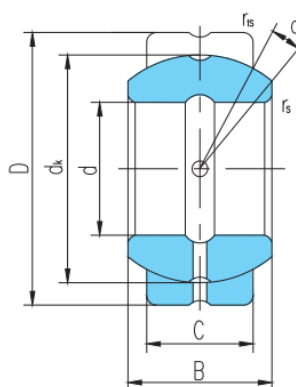

Clasificación de carga básica (kN)
Peso

| Seleccione | Consulta | Número de rodamiento | Dimensiones (mm) | | | | | | | | Clasificación de carga básica (kN) | | Peso corazón kg |
|------------|----------|----------------------|------------------|----|---------------|-----|--------------------|---------------------|------|------|------------------------------------|--|-----------------|
| | | | dk | D | segundo : do: | dk | r _s min | r _{1s} min | un° | cr | | | |
| GEF12ES | 12 | 22 | 11 | 9 | 18 | 0.5 | 0.5 | 7 | 13 | 68 | 0.019 | | |
| GEF15ES | 15 | 26 | 13 | 11 | 22 | 0.5 | 0.5 | 6 | 20 | 102 | 0.031 | | |
| GEF20ES | 20 | 32 | 16 | 14 | 28 | 0.5 | 0.5 | 4 | 33 | 166 | 0.054 | | |
| GEF22ES | 22 | 37 | 19 | 16 | 32 | 0.5 | 0.5 | 6 | 43 | 217 | 0.088 | | |
| GEF25ES | 25 | 42 | 21 | 18 | 36 | 0.5 | 0.5 | 5 | 55 | 275 | 0.128 | | |
| GEF30ES | 30 | 50 | 27 | 23 | 45 | 1 | 1 | 6 | 87 | 439 | 0.232 | | |
| GEF35ES | 35 | 55 | 30 | 26 | 50 | 1 | 1 | 5 | 110 | 552 | 0.291 | | |
| GEF40ES | 40 | 62 | 33 | 28 | 55 | 1 | 1 | 6 | 130 | 654 | 0.392 | | |
| GEF45ES | 45 | 72 | 36 | 31 | 62 | 1 | 1 | 5 | 163 | 816 | 0.609 | | |
| GEF50ES | 50 | 80 | 42 | 36 | 72 | 1 | 1 | 5 | 220 | 1100 | 0.885 | | |
| GEF55ES | 55 | 90 | 47 | 40 | 80 | 1 | 1 | 6 | 272 | 1360 | 1.29 | | |
| GEF60ES | 60 | 100 | 53 | 45 | 90 | 1 | 1 | 6 | 344 | 1720 | 1.84 | | |
| GEF65ES | 65 | 105 | 55 | 47 | 94 | 1 | 1 | 5 | 375 | 1870 | 2.03 | | |
| GEF70ES | 70 | 110 | 58 | 50 | 100 | 1 | 1 | 5 | 425 | 2125 | 2.28 | | |
| GEF75ES | 75 | 120 | 64 | 55 | no | 1 | 1 | 5 | 510 | 2570 | 3.08 | | |
| GEF80ES | 80 | 130 | 70 | 60 | 120 | 1 | 1 | 5 | 610 | 3060 | 4.04 | | |
| GEF85ES | 85 | 135 | 74 | 63 | 125 | 1 | 1 | 6 | 669 | 3340 | 4.44 | | |
| GEF90ES | 90 | 140 | 76 | 65 | 130 | 1 | 1 | 5 | 718 | 3590 | 4.79 | | |
| GEF95ES | 95 | 150 | 82 | 70 | 140 | 1 | 1 | 5 | 833 | 4165 | 6.07 | | |
| GEF100ES | 100 | 160 | 88 | 75 | 150 | 1.5 | 1.5 | 5 | 956 | 4780 | 7.56 | | |
| GEF110ES | 110 | 170 | 93 | 80 | 160 | 1.5 | 1.5 | 5 | 1080 | 5440 | 8.63 | | |

GEF...ES (d 12~150)

| | | | | | | | | | | | |
|----------|-----|-----|-----|-----|-----|-----|-----|---|------|------|------|
| GEF115ES | 115 | 180 | 98 | 85 | 165 | 1.5 | 1.5 | 5 | 1190 | 5960 | 10.4 |
| GEF120ES | 120 | 190 | 105 | 90 | 175 | 1.5 | 1.5 | 6 | 1330 | 6690 | 12.5 |
| GEF130ES | 130 | 200 | 110 | 95 | 185 | 1.5 | 1.5 | 5 | 1490 | 7460 | 14 |
| GEF150ES | 150 | 220 | 120 | 105 | 205 | 1.5 | 1.5 | 5 | 1820 | 9140 | 17.2 |