

SA...C(d 5□30)

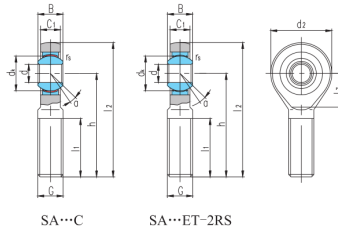

Seleccione	Consulta	Número de rodamiento	Dimensiones (mm)												Clasificación de carga básica (kN)		Peso corazón kg
			dk	segundo :	dk	C ₁ máximo	d ₂	G 6g	h	l ₁ min	l ₂	l ₇	rs min	un°	cr	corazón	
SA5C	5	6	10	4.5	21	M5	36	16	46.5	11.5	0.3	13	3.6	3.9	0.017		
SA6C	6	6	10	4.5	21	M6	36	16	46.5	11.5	0.3	13	3.6	5.5	0.017		
SA8C	8	8	13	6.5	24	M8	42	21	54	13	0.3	15	5.8	10	0.029		
SA10C	10	9	16	7.5	29	M10	48	26	62.5	15.5	0.3	12	8.6	16	0.05		
SA12C	12	10	18	8.5	34	M12	54	28	71	18	0.3	10	11	23	0.066		
SA15C	15	12	22	10.5	40	M14	63	34	83	21	0.3	8	18	32	0.12		
SA17C	17	14	25	11.5	46	M16	69	36	92	24	0.3	10	22	44	0.19		
SA20C	20	16	29	13.5	53	M20x1.5	78	43	104.5	25.5	0.3	9	31	60	0.31		
SA25C	25	20	35.5	18	64	M24x2	94	53	126	31	0.6	7	51	83	0.56		
SA30C	30	22	40.7	20	73	M30x2	110	65	146.5	35.5	0.6	6	65	110	0.89		